

Red Oak Economic Development



RED OAK, TEXAS

Castle Creek Retail

Northeast Corner of SH 342 @ FM 2377

Features

Availability:

- Pad Sites Available

Space Available:

- 11 Acres

Price:

- Call Clyde or Casey

Hargrove @ (972) 617-1100

Location:

- NEC of SH342 & FM 2377

Area Retailers:

Whataburger, Wells Fargo, CVS, Dance Expressions, Snap Fitness, Brookshire's, Red Oak High School, Kid's University, Dairy Queen, and Wal-Mart in Pre-Construction Phase



Traffic Counts:

- SH 342 = 9,830 vpd
- FM 2377 = 5,480 vpd

Demographics

Radius	Est. '11 Pop.	Average HH Inc.	Median HH Inc.	Drive Time	Est. '11 Pop.	Average HH Inc.	Median HH Inc.
3 Mile	22,134	\$66,664	\$56,516	5 Min.	4,882	\$53,940	\$43,218
5 Mile	67,628	\$71,373	\$60,199	10 Min.	50,437	\$65,465	\$54,567
7 Mile	134,567	\$68,860	\$57,525	15 Min.	178,803	\$61,277	\$49,500
10 Mile	277,744	\$64,585	\$53,144	30 Min.	2,016,810	\$63,105	\$45,227



RED OAK, TEXAS

Todd Fuller, Assistant City Manager, City Of Red Oak, PO Box 393, Red Oak, TX 75154

Phone: (972) 617-6831 Fax: (972) 576-0929 Email: roidc@redoaktx.org Website: www.redoaktx.org

Red Oak Economic Development

Valley Ridge Plaza
 Northeast Corner of SH 342 @ FM 2377

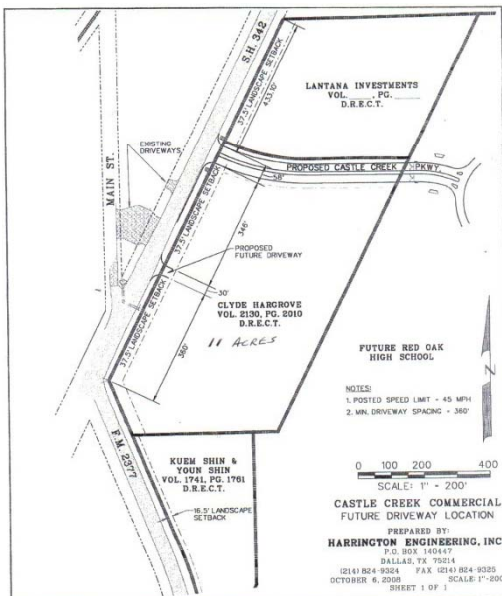
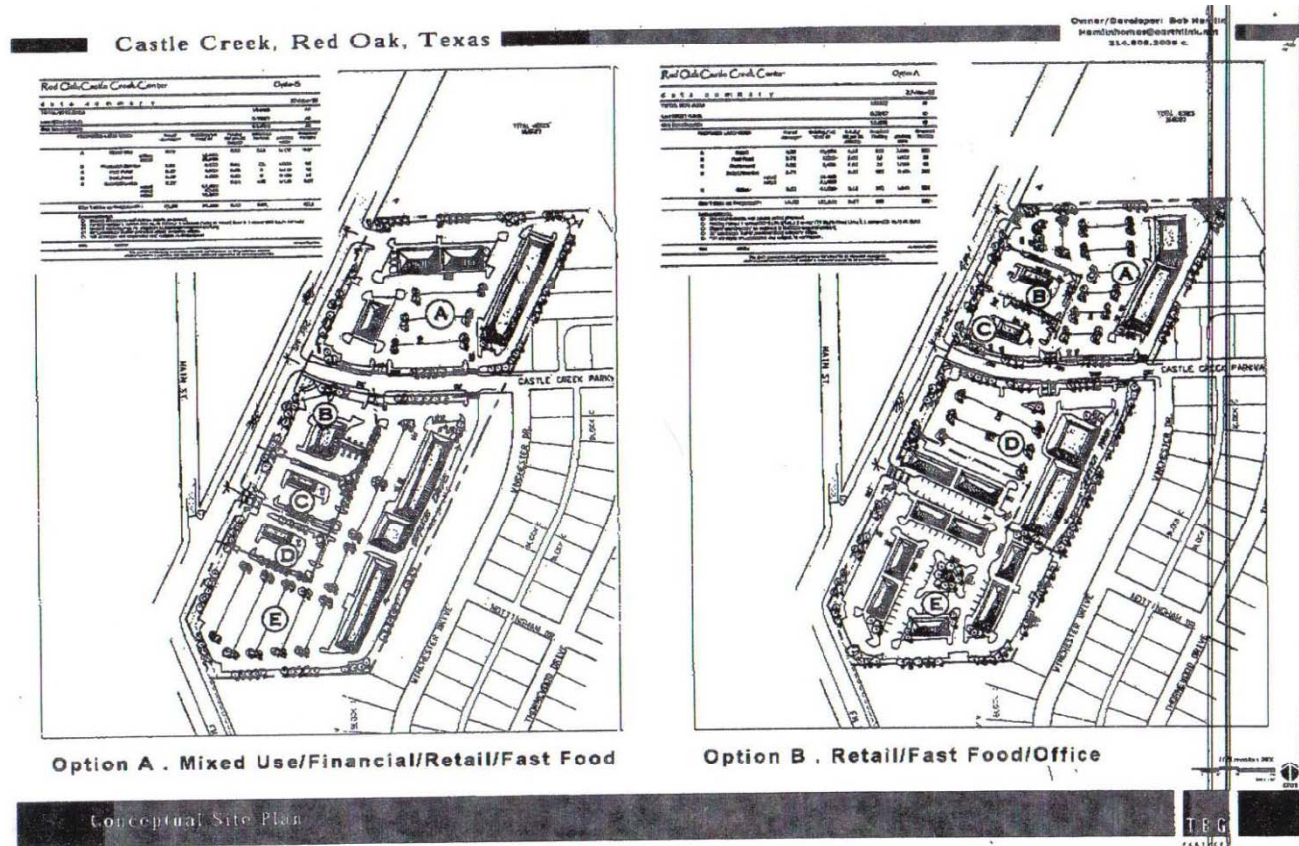

Developed by:
South Bethany Development Company
Clyde Hargrove or
Casey Hargrove
(972) 617-1100



RED OAK, TEXAS

Todd Fuller, Assistant City Manager, City Of Red Oak, PO Box 393, Red Oak, TX 75154

Phone: (972) 617-6831 Fax: (972) 576-0929 Email: roidc@redoaktx.org Website: www.redoaktx.org